



• Designed to draw eyes upwards during the day and project brilliant Tru-Colour brightness in the evenings, the D900 SH Curve increases home thermal efficiency by eliminating the need for large cutouts and gaps in insulation.

D900 SH Curve LED surface



Electrical:	<u>Wattage:</u> 16.5W	<u>Efficacy:</u> 55-56lm/W	<u>Dimming:</u> Yes*	<u>Lifetime:</u> 70,000hrs
Optical:	<u>Lumen output:</u> 900-920lm	<u>Colour temperature:</u> 3000K 4000K	<u>Beam angle:</u> 45°	<u>Tru-Colour:</u> Yes
Physical:	<u>Hole cutout:</u> 20mm	<u>Gimbal angle:</u> N/A	<u>Warranty:</u> 7 years	<u>IP rating:</u> IP40
	<u>Type:</u> Surface-mounted	<u>Fascia style:</u> N/A	<u>Body colour</u> ● White ● Black	<u>Fascia colour</u> N/A

Dimensions:

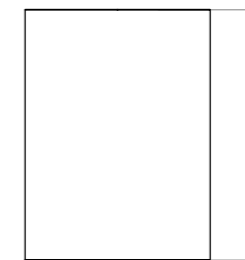
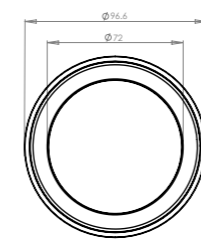

Product codes:

D900.SH-CR-3K-45-W
D900.SH-CR-3K-45-B

D900.SH-CR-4K-45-W
D900.SH-CR-4K-45-B