

W500 IPS ^{Cube} LED wall light

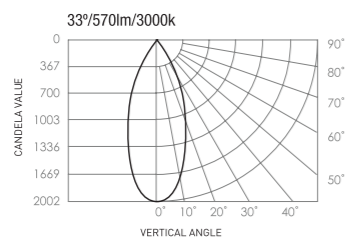

Electrical:	<u>Circuit Wattage:</u> 8.7W	<u>Delivered Light Efficacy:</u> 65lm/W	<u>Dimming:</u> No	<u>Longevity:</u> L70 = 70,000 Hrs
Optical:	<u>Delivered Lumens:</u> 570lm	<u>Colour Temperature:</u> 3000K (3K)	<u>Beam Angle:</u> 33°	<u>Tru-Colour:</u> Yes
Physical:	<u>Hole Cutout:</u> N/A	<u>Gimbal Angle:</u> N/A	<u>Warranty:</u> 3 years of luminaire warranty	<u>IP Rating:</u> IP54
	<u>Type:</u> Wall light	<u>Body Colour:</u> ● Black [B]	<u>Fascia Colour:</u> N/A	<u>Fascia Style:</u> N/A

Photometrics:



Dimensions:

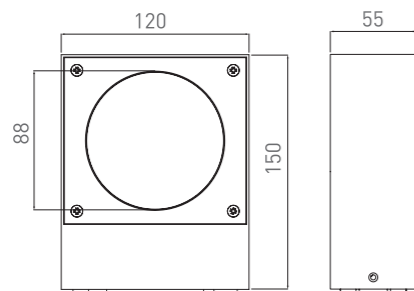

Specifying Product:	<u>Product Name</u>	<u>Family</u>	<u>Colour Temp.</u>	<u>Beam Angle</u>	<u>Body Colour</u>	<u>Version No.</u>	<u>Eg. Product Code</u>
	W500.IPS	CB	3K	33°	Black	1.0	W500.IPS-CB-3K-33-W-1.0

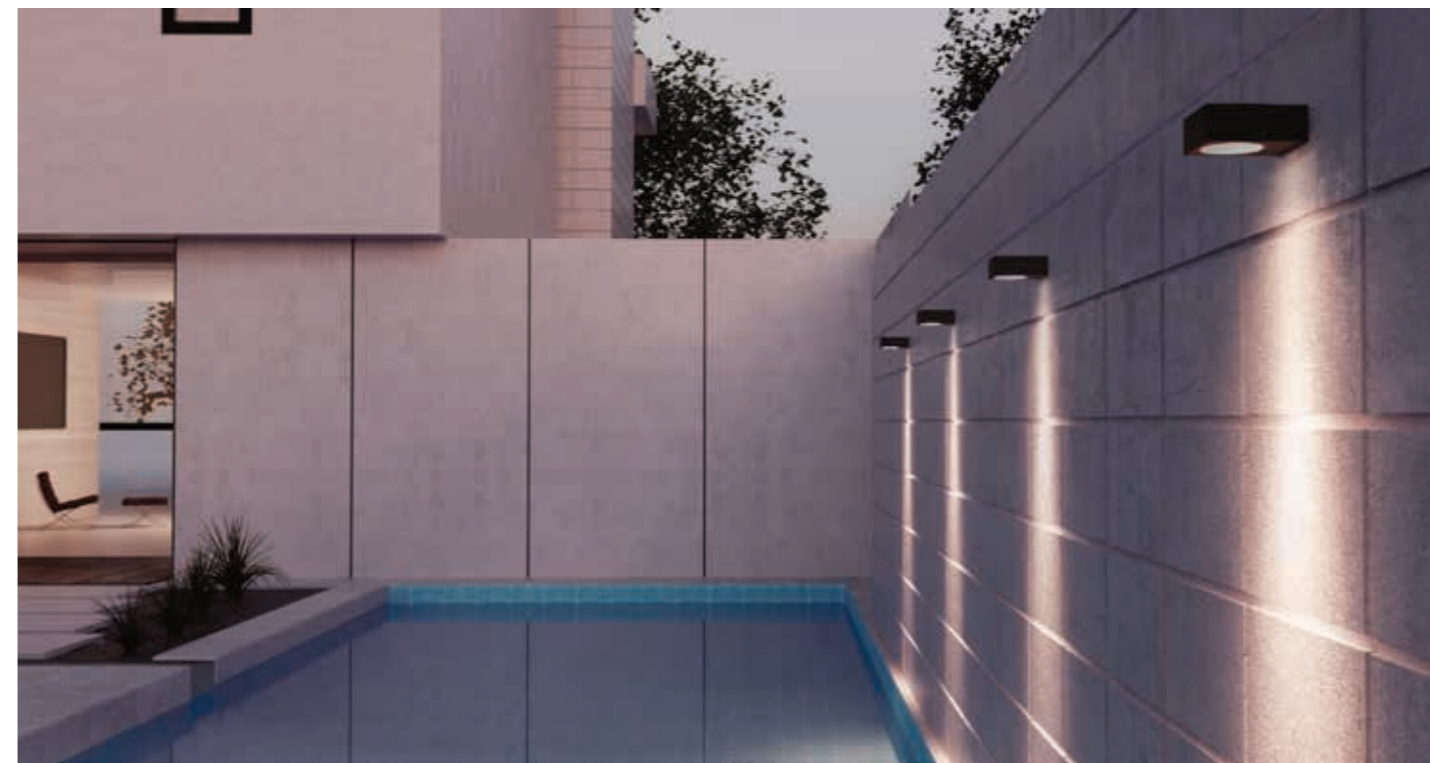

•W500 IPS-CB has a single directional integrated light source. Creates an up or down illumination best used for wall grazing or spotlighting a key area on the ground